

ASSEMBLY INSTRUCTIONS

CAUTION: Read All Instructions Carefully For Safe Operation and Installation.

IMPORTANT: Turn circuit breaker off or remove fuse(s).

CAUTION: Use only copper wire with this device. Do not use with aluminum wire.

To be installed by an electrician or qualified person in accordance with local electrical codes.

Turn off the main power at the circuit breaker before installation, replacing lamp or maintenance.

Safety eye glasses and gloves are recommended to handle them. Safety glasses can protect your eyes when drilling holes overhead.

Wear rubber-soled shoes and work on a sturdy wooden ladder.

Not to be used with light dimmer.

Not to be used with motion sensor.

Replace or install lamp with correct wattage and type as marked on luminaire label.

Use UL listed wire connectors for connections.

REQUIRED TOOLS

Pliers and Wire Strippers

Phillips Head Screwdriver

Flat Head Screwdriver

Adjustable Wrench

Hammer Drill and Drill Bits

Ruler

Hammer

Safety Glasses & Gloves

UL Approved Electrical Tape

INCLUDES

A. Enclosed & gasketed fixture x1

B. Polycarbonate diffuser lens x1

C. Locking latches x10

D. Bracket sets x2

E. Wire nut x2

F. Short screws sets x2

G. Long screw sets x2

H. Washers x4

I. 1/2" Ø threaded water-tight fitting x1

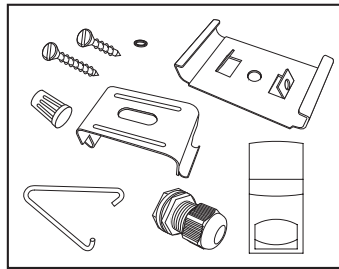

LAMPS REQUIRED

Two (2) T8 32W lamps (Not included)

BASE LOCKING

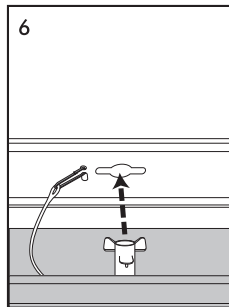

Insert locking pin through the designated hole in the reflector.

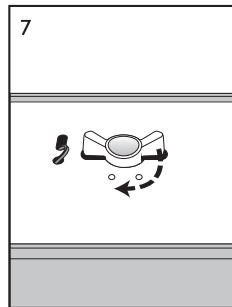

Rotate the locking pin 1/4 turn to secure lamp reflector.

REMOVING THE REFLECTOR

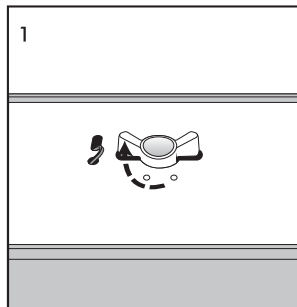

Rotate the locking pin 1/4 turn to remove the reflector and locate hardware.

LAMP HOLDER INSTALLATION

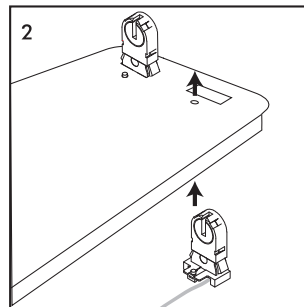

Insert (pressure fit) fluorescent lamp holder through designated opening on reflector (follow instructions on ballast cover).

POWER CONNECTION

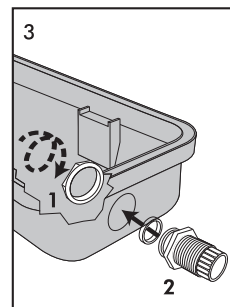

Connect 1/2" Ø threaded water-tight fitting to the gasketed enclosure housing (included)

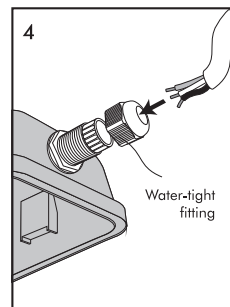

Insert power cable through the Water-tight fitting and tighten firmly.

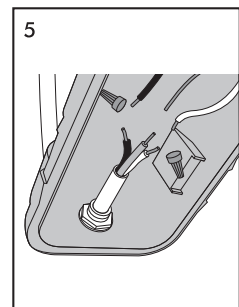

Using the wire nuts (included) to connect supply wires to wires in the fixture: black to black, white to white and green to bare ground wire. Ensure that there are no strands of wire exposed.

LAMP INSTALLATION

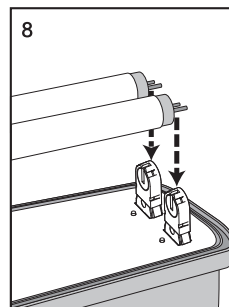

Insert two T8 32W lamps into socket and twist 1/4 turn to secure.

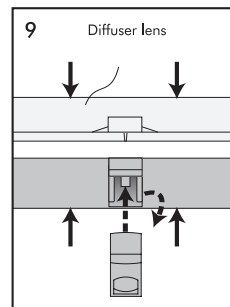

Place the diffuser lens on the enclosure gasket fixture and secure with the snap on locking latches.

BRACKET INSTALLATION

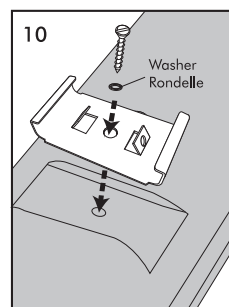

Connect the base of the bracket to the back of the gasketed enclosure housing using short screws supplied.

SUSPENSION MOUNT

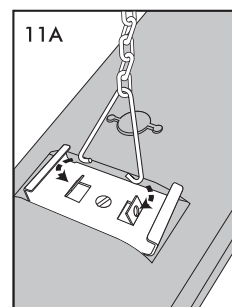

Insert hanging chain (not included) into "V" clip. Attach "V" clip to the base bracket.

CEILING/WALL MOUNT

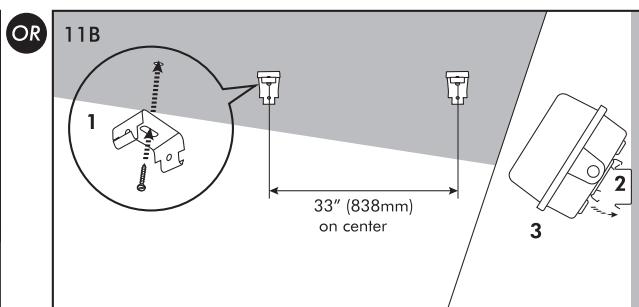

Secure snap-clip to the ceiling or wall using long screws (included). Place snap-clips 33" (838mm) apart on center. Place fixture on an angle to the wall or ceiling and make sure that one side of the snap-clips goes inside the base bracket. Push the other side of fixture against the wall or ceiling until you hear a snapping sound (other side of snap-clip goes into the base bracket).